

Dimension: (Unit: mm)

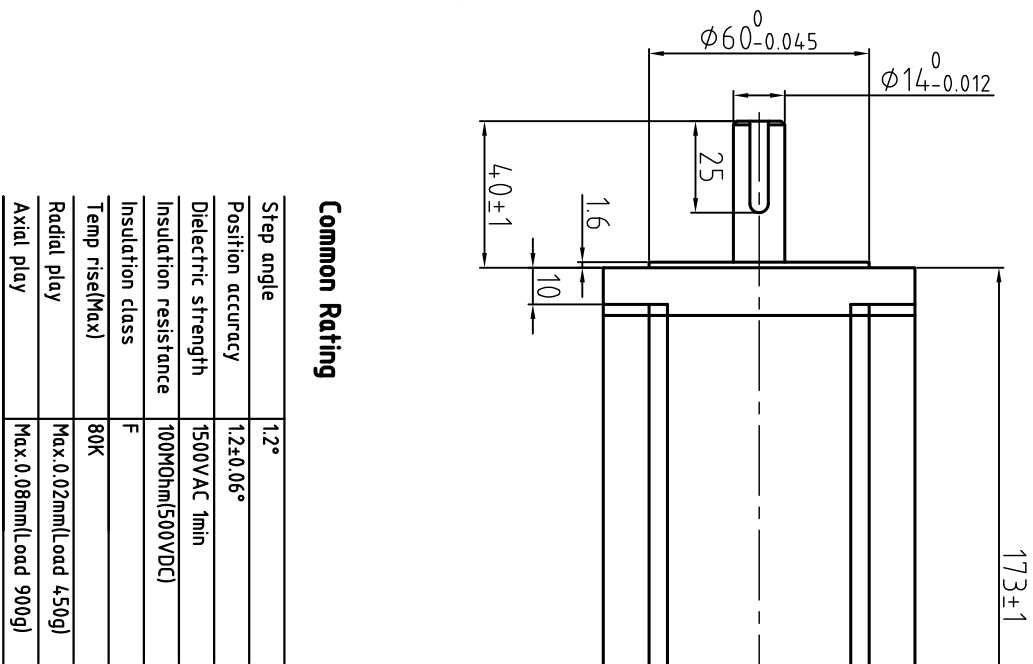

Common Rating

Step angle	12°
Position accuracy	12±0.06°
Dielectric strength	1500VAC 1min
Insulation resistance	100MΩhm(500VDC)
Insulation class	F
Temp rise(Max)	80K
Radial play	Max:0.02mm(Load 450g)
Axial play	Max:0.08mm(Load 900g)

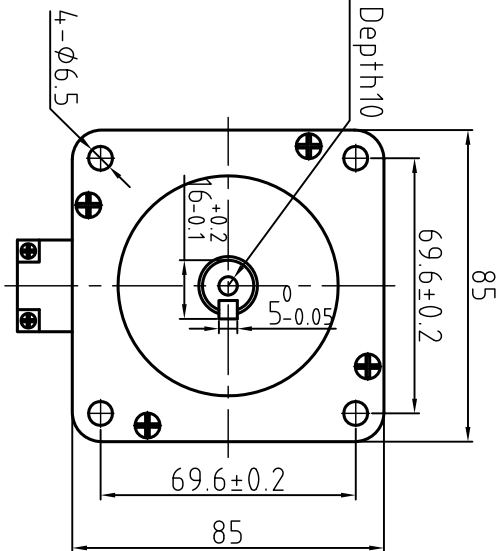
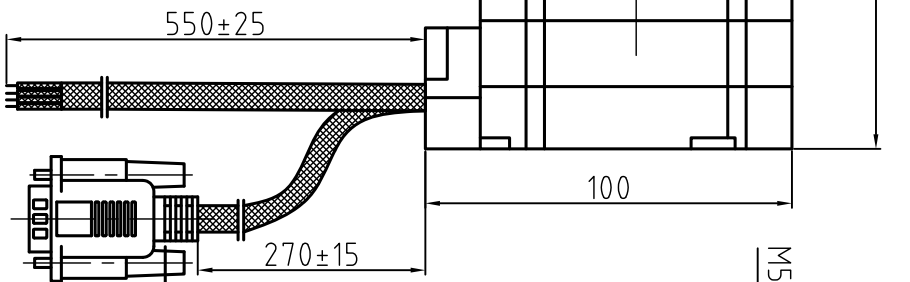

Motor Connections

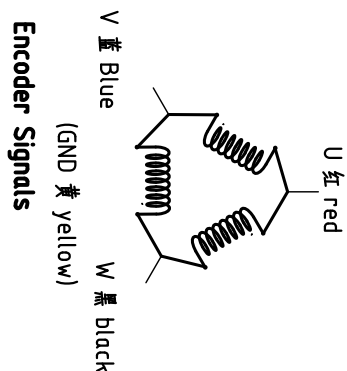

Encoder Signals

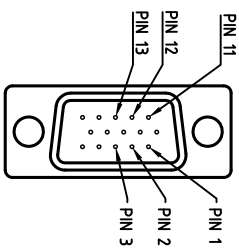

PIN	1	2	3	11	12	13
颜色	黑	红	白	黄	绿	蓝
定义	A+	VCC	GND	B+	B-	A-

Specification

Current/phase	3 A
Voltage	7 V
DC Resistance/phase ±10%	2.34, Ω
Inductance/phase	±20% 18.33 mH
Holding torque	8 N·M
Inertia	4 kg·cm ²
Weight	5.6 kg
Encoder Resolution	1000 cpr

设计 Designed	日期 Date	材料 Material	深圳市雷赛智能控制股份有限公司 SHENZHEN LEADSHINE TECHNOLOGY CO., LTD.
审核 Checked		第一角画法 First angle projection	混合伺服电机
批准 Approved		重量/比例 Weight/Scale	863HBM80H-1000
料号 Part No.		共 1 套 第 1 套 Sheet 1 of 1	图号 DWG. NO. LS-HBM86-H36-0010-01

版本 Rev	日期 Date	变更文件号 ECR NO.	变更内容 Revisions	设计 By
V1.0	13.7.3		初版	王平