

Hybrid Stepping Motor

Type: **39HS02**

Rev: B

Date: 20080310

● COMMON RATINGS

Step angle: 1.8°	Dielectric strength: 500VAC
Positional accuracy: ± 5%	Insulation resistance: 100Mohm (500VAC)
Number of Phase: 2	Radial play:
Temperature rise: 80°C MAX	Insulating class: B
Rotor Inertia: gcm ²	Weight: 0.20 kg

● SPECIFICATIONS

Holding torque (2 phases on) kg. cm	Rated Current/Phase (Amps DC)	Phase Resistance (ohms) ± 10%	Voltage Current/Phase (V DC)	Phase Inductance (mH) ± 20% (1KHz) Typicat
2.2	06	15	9	16

● DIMENSIONS unit=mm

● CONNECTIONS

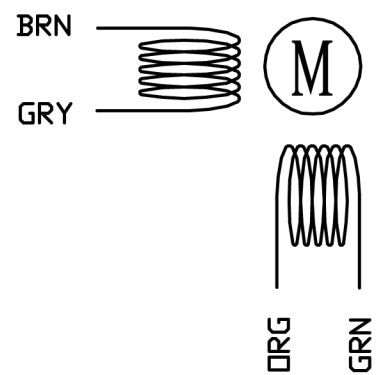
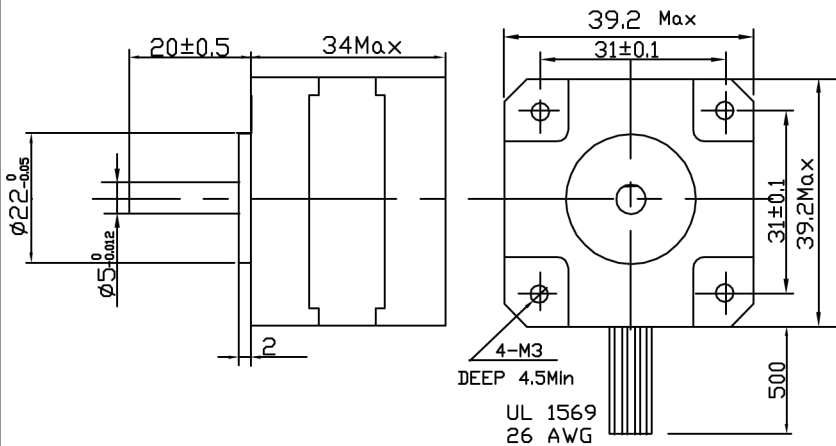

					39HS02			技术规格书	
标记	处数	分区	更改文件号	签名	日期				
设计			标准化			阶段标记	重量	比例	
审核									
工艺			批准			共 张		第 张	
深圳市雷赛智能控制股份有限公司									