

Dimension: (Unit: mm)

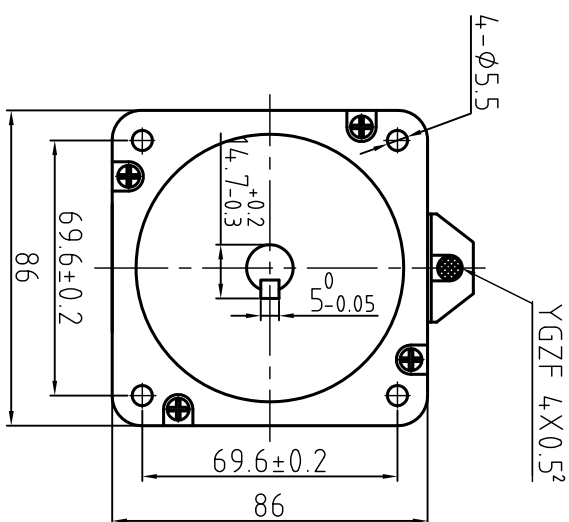

Motor Connections

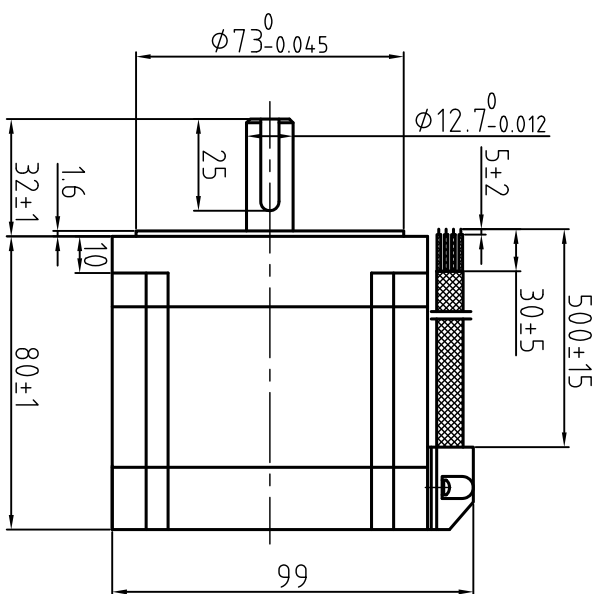
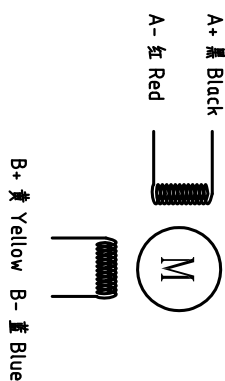

版本 Rev	日期 Date	变更文件号 ECR NO.	变更内容 Revisions	设计 By
V1.0	14.8.4		型号为: 86HS45D	王平
V1.1	14.9.15		增加压线块, 改为轴向出线	王平

Common Rating

Step angle	1.8°
Position accuracy	18±0.09°
Dielectric strength	500VAC 1min
Insulation resistance	100MΩmin(500VDC)
Insulation class	B
Temp rise(Max)	80K
Radial play	Max.0.02mm(Load 450g)
Axial play	Max.0.08mm(Load 900g)

Specification:

Current/phase	4.0 A
Voltage	3 V
DC Resistance/phase	0.47 Ω
Inductance/phase	3.6 mH
Holding torque	4.5N·M
Inertia	195 kg·cm²
Weight	2.5 kg

设计 Designed	日期 Date	材料 Material	深圳市雷赛智能控制股份有限公司 SHENZHEN LEADSHINE TECHNOLOGY CO., LTD.
审核 Checked		第一角画法 First Angle projection	混合式步进马达
批准 Approved		重量/比例 Weight/Scale	86HS45D
图号 Part No.		图号 DWG. NO.	

共 1 套 第 1 套 Sheet 1 of 1